

Assembly Instructions for *In the Breeze* Momma Bugs & Birds

1. Remove twist tie from the assembled Windee Wheel hubs.
2. Take the Support Tube off the fiberglass shaft.

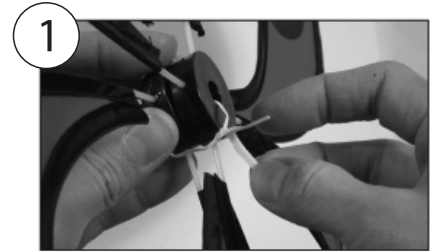

3. Slide the two Windee Wheel hubs over the fiberglass shaft and replace Support Tube. *Note: make sure the smaller opening of the support tube is toward the Windee Wheel.*



4. Insert the body section into the pressure lock on the fiberglass shaft. *Note: the body section should be vertical with the ground.*

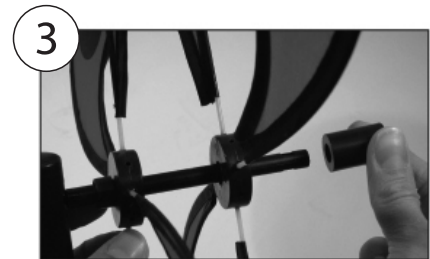

5. Slide the Support Tube back towards the body section to cover the pressure lock opening, pushing the support tube as far back towards the body section as possible.

