

Assembly Instructions for ITB-19 - Vertical Standing Display Rack

1. Identify the top grid panel - it has two display tubes welded to the inside of the grid frame.
2. Locate the bottom cross supports and slide the bottom panel of the grid into the cross supports. Tighten thumb screws to secure.
3. Slide the top panel of the grid into the bottom grid panel and tighten thumb screws to secure.
4. Slide wire brace onto the top of the display to hold signage.

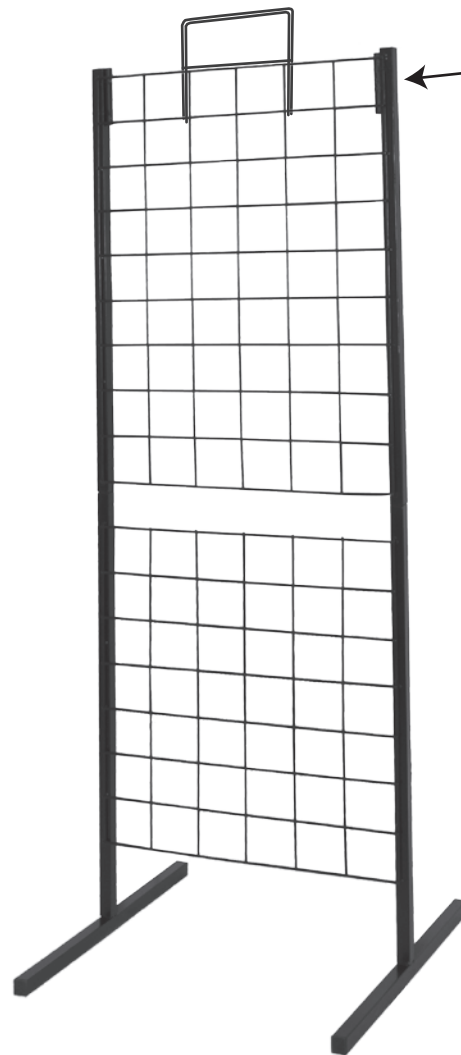
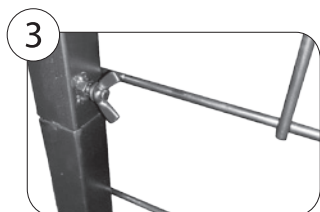
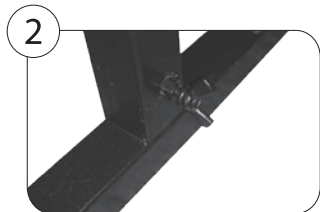

DISPLAY NOTES:

Use the tubes at the top to display ground spinner products.

For additional display options you can remove the plastic caps on the top of the rack and display spinners with ground stakes.



example of a loaded display

